



# Naylors

ESTATE AGENTS CHARTERED SURVEYORS



## 14 Church Street

, Billesdon, LE7 9AE

**£1,050 Per Calendar Month**

An opportunity to rent this traditional two bedroom, mid terraced property in the heart of the popular village of Billesdon.

The accommodation in brief comprises: Sitting room, fully fitted kitchen, ground floor WC, two bedrooms, shower room and garden to rear.

- Village location
- Two bedrooms
- Kitchen
- Shower room
- Sitting room
- West facing garden
- EPC D

### Viewing

Please contact our Market Harborough Office on 01858 450020 if you wish to arrange a viewing appointment for this property or require further information.

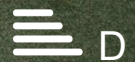

## Floor Plan

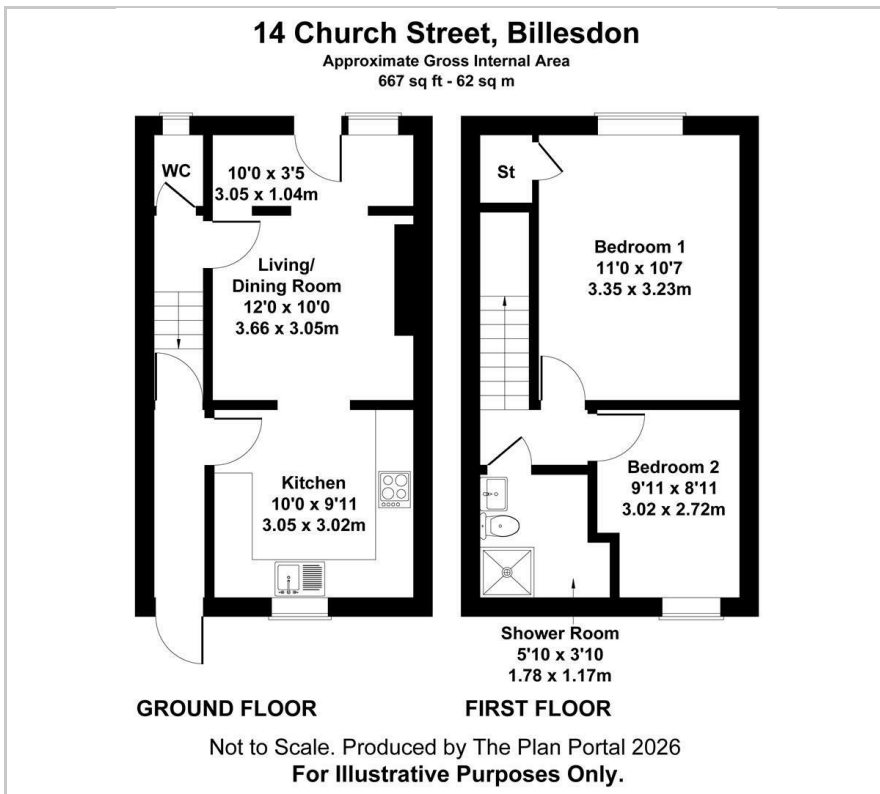

## Area Map



## Energy Efficiency Graph

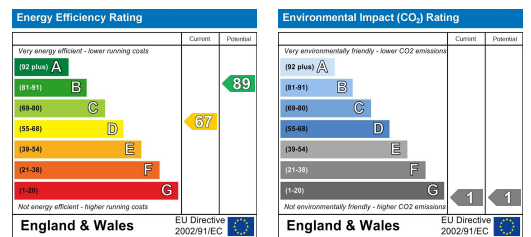

These particulars, whilst believed to be accurate are set out as a general outline only for guidance and do not constitute any part of an offer or contract. Intending purchasers should not rely on them as statements of representation of fact, but must satisfy themselves by inspection or otherwise as to their accuracy. No person in this firm's employment has the authority to make or give any representation or warranty in respect of the property.